

Model A Ford DISTRIBUTOR ASSEMBLY 1928-1931

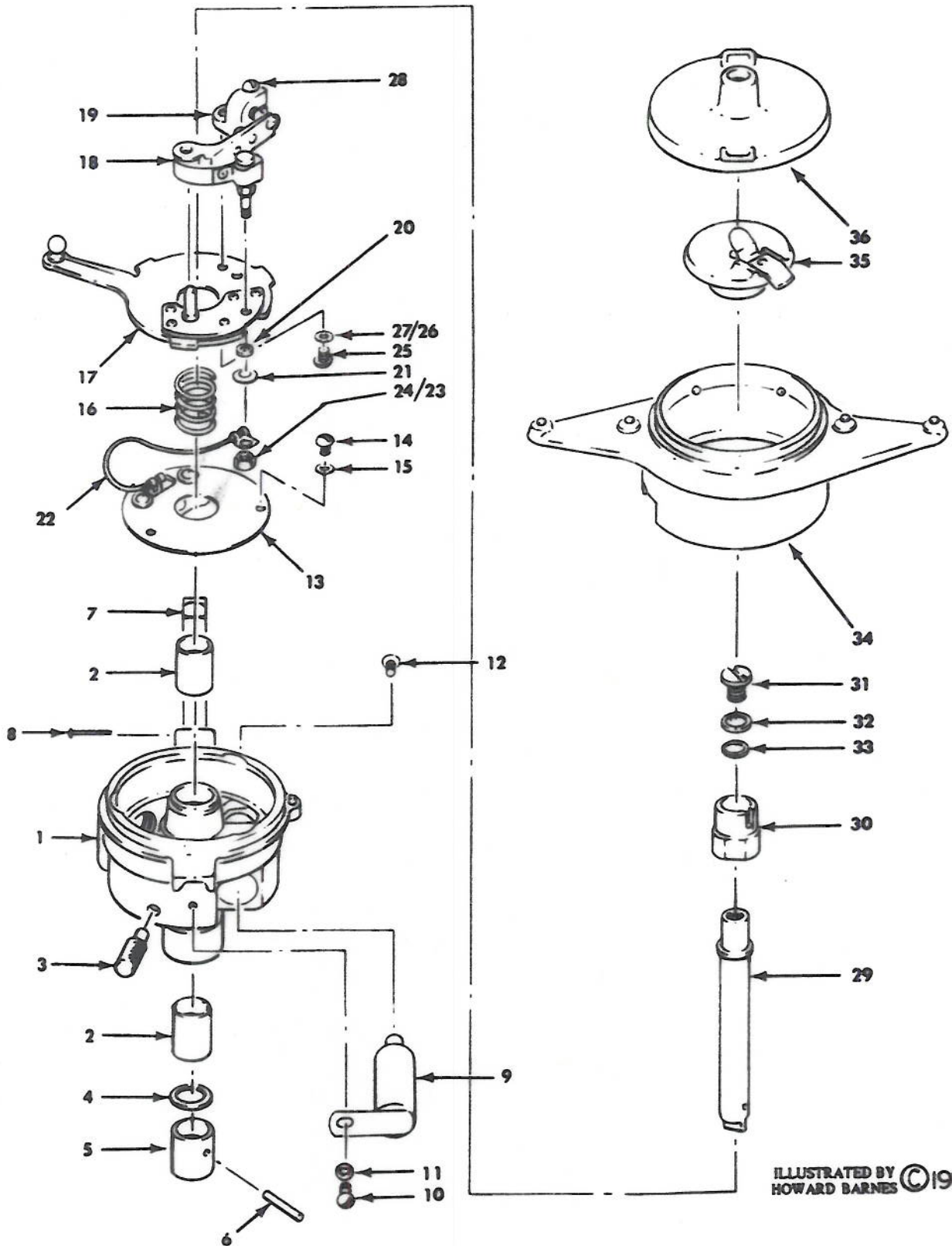

ILLUSTRATED BY HOWARD BARNES © 1989

Distributed by:
 Model A Ford Club of America
 250 S. Cypress Street
 La Habra, California 90631

**Model A Ford
DISTRUBTOR ASSEMBLY
1928-1931**

Index Number	Part Number	Nomenclature	Number Required
1	A-12130	Distributor Base Assembly	1
2	A-12132	Distributor Base Bushing	2
3	A-12135	Distributor Base Oiler	1
4	A-22331	Fiber Washer 1/2" (3/16 x 3/4)	1
5	A-12195	Shaft Sleeve	1
6	A-23670	Sleeve Pin	1
7	A-12144	Distributor Cap Clamp	2
8	A-22902	Oval Head Split Rivet (1/8 x 15/16)	2
9	A-12300	Condensor	1
10	A-20160-S7	Round Head Screw #8-32 (x 1/4)	1
11	A-22056	Lockwasher #8 (3/64 x 3/16)	1
12	A-20223-S5	Round Head Screw #10-32 (x 1/4)	1
13	A-12148	Bus Bar (Lower Plate) Support Assembly	1
14	A-20106-S7	Round Head Screw #8-32 (x 1/4)	2
15	A-22056	Lockwasher #8 (3/64 x 3/16)	2
16	A-12137	Distributor Breaker Plate Friction Spring	1
17	A-12151	Breaker Plate (Upper) & Insulator Assembly	1
18	A-12162	Point Breaker Arm Assembly	1
19	A-12160	Contact Screw Bracket	1
20	A-22072-S6	Washer (Steel Spacer)	1
21	-	Fiber Washer	1
22	-	Pigtail	1
23	A-22056	Lockwasher #8 (3/64 x 3/16)	1
24	A-21548-S7	Hex Nut #8-36 (5/32 x 5/16)	1
25	A-20116-S8	Round Head Screw (#8-32 x 5/16)	2
26	A-22071-S7	Plain Washer 11/64" (1/32 x 3/8)	2
27	A-22056	Lockwasher #8 (3/64 x 3/16)	2
28	A-20067-S7	Fillister Head Screw #6-32 (x 7/16)	1
	A-22047	Lockwasher #6 (1/32 x 17/64)	1
	-	Flat Washer 5/16"	1
29	A-12178	Cam Shaft	1
30	A-12210	Distributor Cam	1
31	A-20106-S7	Round Head Cam Screw #8-32 (x 1/4)	1
32	A-22236	Lockwasher 5/16" (1/32 x 17/32)	1
33	A-22222-S7	Plain Washer 5/16" (1/32 x 35/64)	1
34	A-12105	Distributor Body	1
35	A-12200	Distributor Rotor	1
36	A-12115	Distributor Cap	1